



ABN 43 064 478 842

➤ 231 Osborne Avenue Clayton South, VIC 3169
 PO Box 1548, Clayton South, VIC 3169
 t 03 9265 7400 f 03 9558 0875
 freecall 1800 680 680
www.tmgtestequipment.com.au

Test & Measurement

- sales
- rentals
- calibration
- repair
- disposal

Complimentary Reference Material

This PDF has been made available as a complimentary service for you to assist in evaluating this model for your testing requirements.

TMG offers a wide range of test equipment solutions, from renting short to long term, buying refurbished and purchasing new. Financing options, such as Financial Rental, and Leasing are also available on application.

TMG will assist if you are unsure whether this model will suit your requirements.

Call TMG if you need to organise repair and/or calibrate your unit.

If you click on the “Click-to-Call” logo below, you can call us for FREE!

TMG Corporate Website

TMG Products Website



Click-to-Call
TMG Now

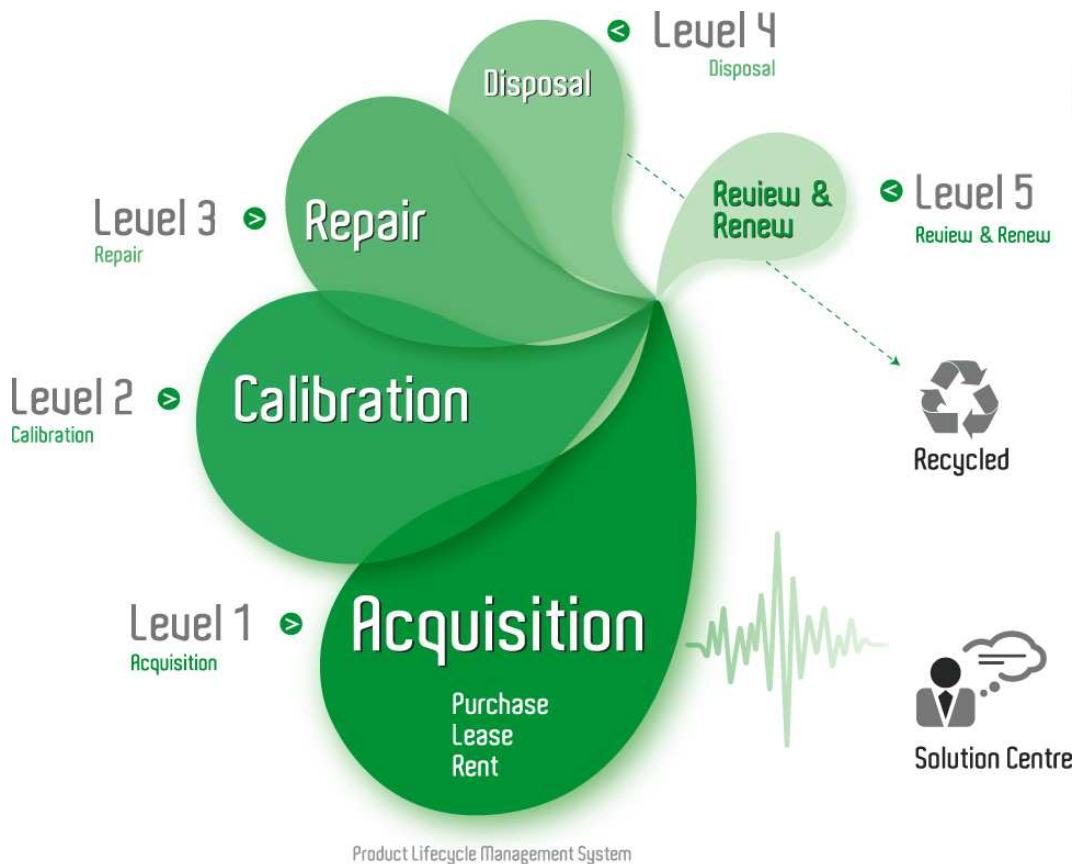

Product Lifecycle Management System

Disclaimer:

All trademarks appearing within this PDF are trademarks of their respective owners.



Instructions

Tektronix

**P6101B
15 MHz 1X Passive Probe**

070-7819-07



Copyright © Tektronix, Inc. All rights reserved.

Tektronix products are covered by U.S. and foreign patents, issued and pending. Information in this publication supercedes that in all previously published material. Specifications and price change privileges reserved.

Printed in the U.S.A.

Tektronix, Inc., P.O. Box 1000, Wilsonville, OR 97070-1000

TEKTRONIX and TEK are registered trademarks of Tektronix, Inc.

General Safety Summary

Review the following safety precautions to avoid injury and prevent damage to this product or any products connected to it. To avoid potential hazards, use this product only as specified.

To Avoid Fire or Personal Injury

Observe Maximum Working Voltage. Do not use the P6101B probe above 300 V_{RMS}, CAT II. Refer to the derating chart, Figure 1, on page 7.

Do Not Elevate the Common Terminal. The common terminal is at ground potential. Do not connect the common terminal to elevated voltages.

Do Not Operate With Suspected Failures. If you suspect there is damage to this product, have it inspected by qualified service personnel.

Do Not Operate in Wet/Damp Conditions.

Do Not Operate in an Explosive Atmosphere.

Keep Product Surfaces Clean and Dry.

Safety Terms and Symbols

Terms in This Manual. These terms may appear in this manual:



WARNING. Warning statements identify conditions or practices that could result in injury or loss of life.



CAUTION. Caution statements identify conditions or practices that could result in damage to this product or other property.

Features and Accessories

The P6101B probe is compatible with most general purpose oscilloscopes that have a 1 M Ω input impedance and bandwidth up to 15 MHz.

NOTE. Remove and discard the protective cover on the tip of the probe before attempting to connect a probe tip accessory.

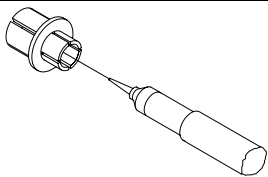

BNC-to-probe tip adapter. To install the adapter, push the wide end firmly into a BNC connector. Then insert the probe tip firmly into the adapter.

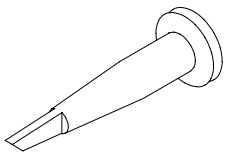

Retractable hook tip. Use the retractable hook tip to make hands-free measurements.

NOTE. For a solid connection, firmly push and twist the hook tip onto the probe tip before using.

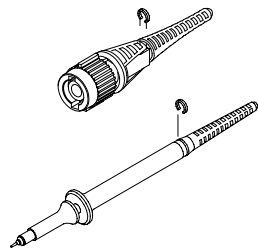

Marker rings. Attach the matching colored rings onto the probe cable and tip as shown.

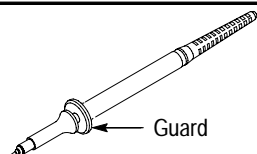

Guard. The guard provides a finger barrier for protection from electric shock.



WARNING. To avoid electric shock when using the probe, keep fingers behind the guard on the probe body.

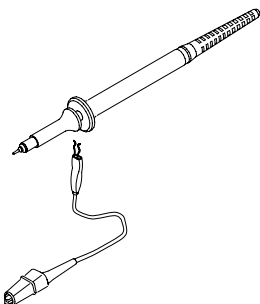

Ground Lead. Use the alligator clip to attach the probe to a ground reference.

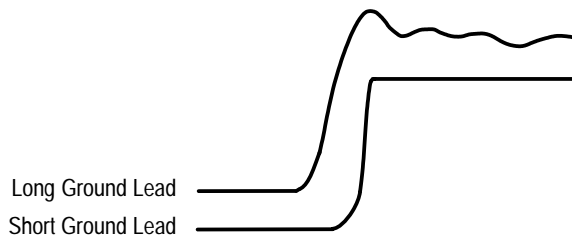

To see the best signal, use the shortest possible ground lead and signal path.



Maintenance

This section describes how to maintain the probe.

Cleaning

To prevent damage to probe materials, avoid using chemicals that contain benzene, benzene, toluene, xylene, acetone, or similar solvents.

Do not immerse the probe or use abrasive cleaners.

Dirt may be removed with a soft cloth dampened with a mild detergent and water solution, or isopropyl alcohol.

Replacing Probe Parts

Other than accessories, only the probe tip is replaceable.

Replacement probe tips are available as optional accessories. Refer to the replaceable parts list at the end of this manual for more information.

To remove a tip assembly, firmly grasp the pointed tip with pliers and withdraw the assembly from the barrel.

No tools are required to install a replacement tip. Insert a new probe tip into the probe barrel as far as possible using finger pressure. If necessary, seat the plastic portion of the tip against the probe barrel by pressing the tip gently but firmly against a hard surface, such as a wood block or table top.

Specifications

These characteristics apply to a P6101B probe. The instrument connected to the probe must have a warm-up period of at least 20 minutes and be in an environment that does not exceed the limits described in Table 2.

Table 1: Electrical Characteristics

Attenuation (system)	1X \pm 1.05% at DC
Input Resistance (system)	1 M Ω \pm 1.0%
Input Capacitance	100 pF typical
System Bandwidth (-3 dB)	DC to 15 MHz
Maximum Working (Nondestructive) Input Voltage	300 V, CAT II (See Figure 1 on page 7)

Specifications

Table 2: Physical and Environmental Characteristics

Net Weight (including accessories)	< 320 g (0.7 lb)
Cable Length	2 meters
Temperature Range ¹	
Operating	-15° C to +65° C (+5° F to +149° F)
Nonoperating	-62° C to +85° C (-80° F to +185° F)
Humidity ¹	95% to 97% Relative Humidity (30°C to 60°C)

¹ Tektronix Standard 062-2847-00, class 3. Refer to MIL-E-16400F, paragraph 4.5.9 through 4.5.9.5.1, class 4.

Table 3: Certifications and compliances

EC Declaration of Conformity – Low Voltage	Compliance was demonstrated to the following specification as listed in the Official Journal of the European Communities: Low Voltage Directive 73/23/EEC, as amended by 93/68/EEC: EN 61010-1/A2:1995 Safety requirements for electrical equipment for measurement, control, and laboratory use EN 61010-2-031:1994 Particular requirements for hand-held probe assemblies for electrical measurement and test equipment
Approvals	UL3111-1 – Standard for electrical measuring and test equipment IEC 1010-2-031 – Particular requirements for hand-held probe assemblies for electrical measurement and test CAN/CSA-C22.2 No. 1010.1-92 and CAN/CSA-C22.2 No. 1010.2.031-94 – Safety requirements for electrical equipment for measurement, control, and laboratory use

Table 3: Certifications and compliances (Cont.)

Installation Category Descriptions	<p>Terminals on this product may have different installation category designations. The installation categories are:</p> <p>CAT III Distribution-level mains (usually permanently connected). Equipment at this level is typically in a fixed industrial location</p> <p>CAT II Local-level mains (wall sockets). Equipment at this level includes appliances, portable tools, and similar products. Equipment is usually cord-connected</p> <p>CAT I Secondary (signal level) or battery operated circuits of electronic equipment</p>
Pollution Degree 2	Do not operate in environments where conductive pollutants may be present.

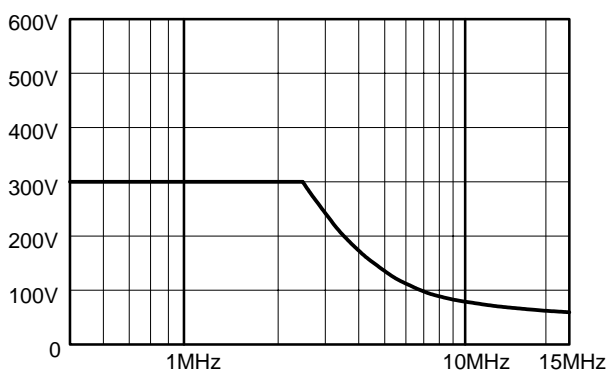

Figure 1: Maximum Working Voltage Derating Curve (V_{RMS})

Replaceable Parts

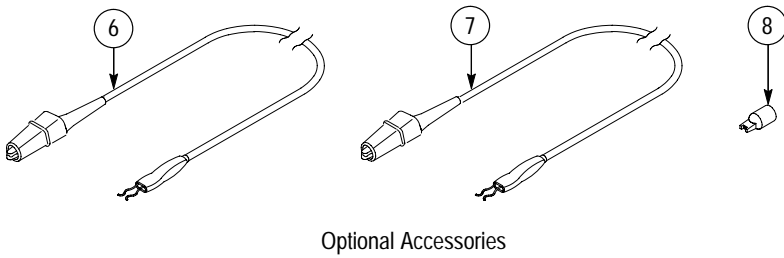
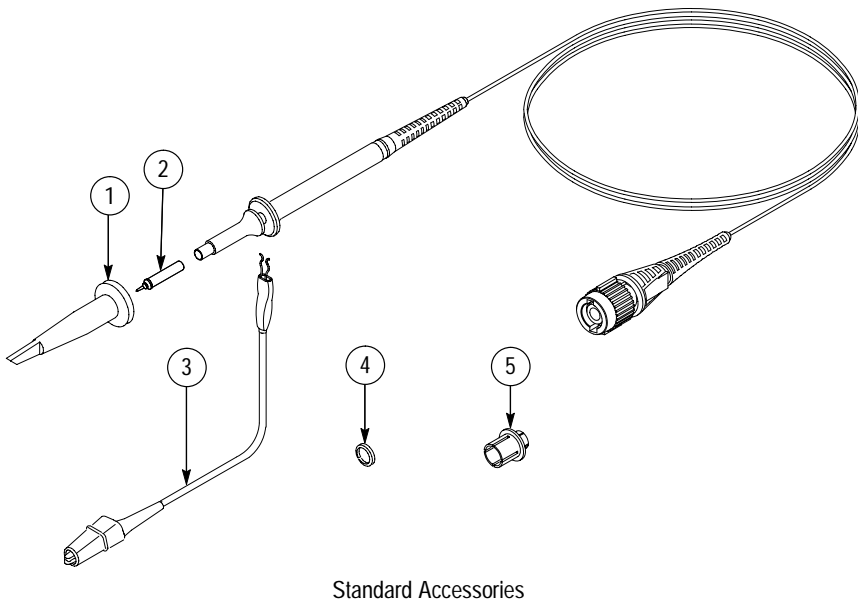

Figure 2: P6101B replaceable parts

Replaceable Parts List

Fig. & Index Number	Tektronix Part Number	Serial No. Effective	Serial No. Discont'd	Qty	Name & Description	Mfr. Code	Mfr. Part Number
2-	-----			1	PROBE,PASSIVE:P6101B		
					STANDARD ACCESSORIES		
	020-2134-01			1	ACCESSORY KIT:MINIATURE SIZE (Includes items 1, 3, 4, & 5)	80009	020-2134-01
-1	013-0107-08			1	TIP,PROBE:MINIATURE/COMPACT SIZE	TK2565	013-0107-08
-2	See Opt. Acc			1	CONTACT,ELEC:PROBE TIP W/INSULATOR ASSY		
-3	196-3120-01			1	LEAD,ELECTRICAL:PROBE GND,6.0 L	80009	196-3120-01
-4	016-0633-00			1	MARKER SET,CA:2 EA VARIOUS COLORS	80009	016-0633-00
-5	013-0277-00			1	ADAPTER,CONN:BNC TO MINIATURE PROBE TIP	24931	33A129-1
	070-7819-07			1	MANUAL,TECH:INSTR, P6101B, DP	80009	070-7819-07
					OPTIONAL ACCESSORIES		
-2	131-4997-01			1	CONTACT,ELEC:2 TIP-INSULATOR W/INFO CARD	80009	131-4997-01
-6	196-3120-21			1	LEAD,ELECTRICAL:PROBE GND,28.0 L	80009	196-3120-21
-7	196-3121-01			1	LEAD,ELECTRICAL:PROBE GND,12.0 L	80009	196-3121-01
-8	015-0201-07			1	TIP,PROBE:IC TEST,PKG OF 10	80009	015-0201-07
	013-0107-07			1	TIP,PROBE:MINIATURE/COMPACT SIZE,GRAY	TK2565	013-0107-07

Manufacturers Cross Index

Mfr. Code	Manufacturer	Address	City, State, Zip Code
24931	BERG ELECTRONICS INC	BERG ELECTRONICS RF/COAXIAL DIV 2100 EARLYWOOD DR PO BOX 547	FRANKLIN, IN 46131
80009	TEKTRONIX INC	14150 SW KARL BRAUN DR PO BOX 500	BEAVERTON, OR 97077-0001
TK2565	VISION PLASTICS INC	26000 SW PARKWAY CENTER DRIVE	WILSONVILLE, OR 97070

Replaceable Parts

WARRANTY

Tektronix warrants that the products that it manufactures and sells will be free from defects in materials and workmanship for a period of one (1) year from the date of shipment. If a product proves defective during this warranty period, Tektronix, at its option, either will repair the defective product without charge for parts and labor, or will provide a replacement in exchange for the defective product.

In order to obtain service under this warranty, Customer must notify Tektronix of the defect before the expiration of the warranty period and make suitable arrangements for the performance of service. Customer shall be responsible for packaging and shipping the defective product to the service center designated by Tektronix, with shipping charges prepaid. Tektronix shall pay for the return of the product to Customer if the shipment is to a location within the country in which the Tektronix service center is located. Customer shall be responsible for paying all shipping charges, duties, taxes, and any other charges for products returned to any other locations.

This warranty shall not apply to any defect, failure or damage caused by improper use or improper or inadequate maintenance and care. Tektronix shall not be obligated to furnish service under this warranty a) to repair damage resulting from attempts by personnel other than Tektronix representatives to install, repair or service the product; b) to repair damage resulting from improper use or connection to incompatible equipment; c) to repair any damage or malfunction caused by the use of non-Tektronix supplies; or d) to service a product that has been modified or integrated with other products when the effect of such modification or integration increases the time or difficulty of servicing the product.

THIS WARRANTY IS GIVEN BY TEKTRONIX IN LIEU OF ANY OTHER WARRANTIES, EXPRESS OR IMPLIED. TEKTRONIX AND ITS VENDORS DISCLAIM ANY IMPLIED WARRANTIES OF MERCHANTABILITY OR FITNESS FOR A PARTICULAR PURPOSE. TEKTRONIX' RESPONSIBILITY TO REPAIR OR REPLACE DEFECTIVE PRODUCTS IS THE SOLE AND EXCLUSIVE REMEDY PROVIDED TO THE CUSTOMER FOR BREACH OF THIS WARRANTY. TEKTRONIX AND ITS VENDORS WILL NOT BE LIABLE FOR ANY INDIRECT, SPECIAL, INCIDENTAL, OR CONSEQUENTIAL DAMAGES IRRESPECTIVE OF WHETHER TEKTRONIX OR THE VENDOR HAS ADVANCE NOTICE OF THE POSSIBILITY OF SUCH DAMAGES.